

TULIPIIPPUTM

CleanFire

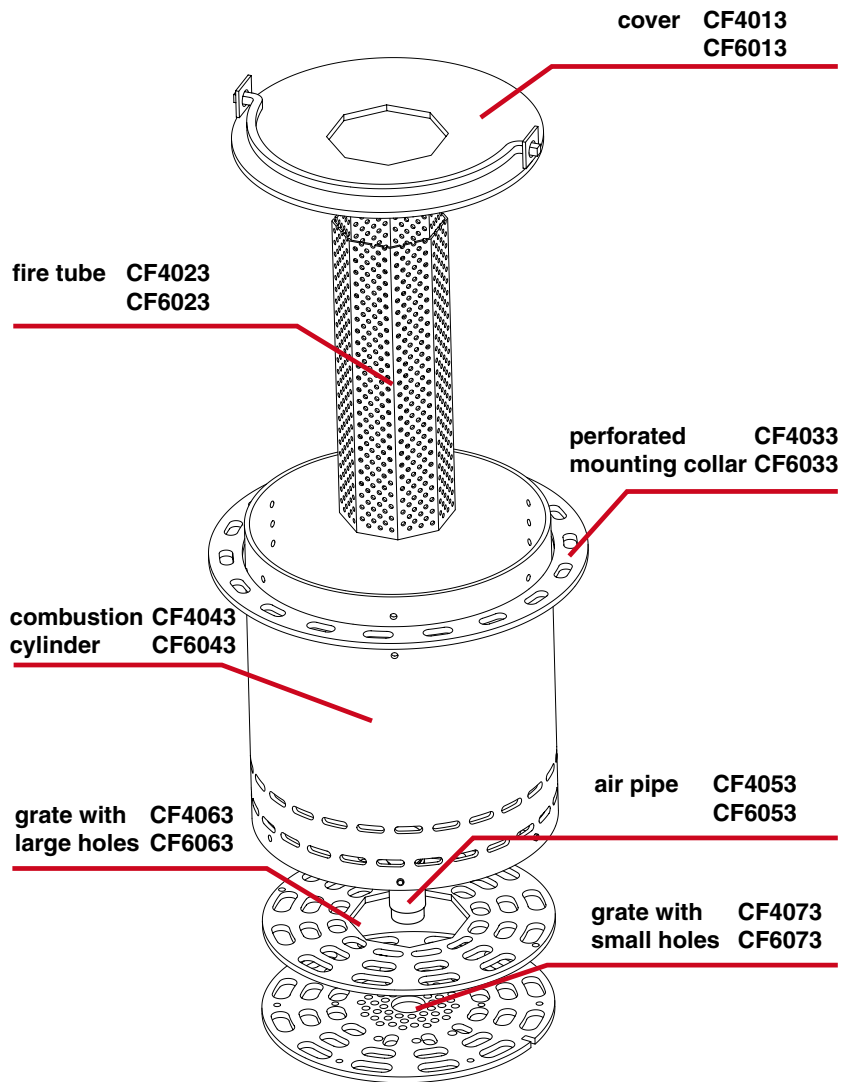

TULIIPPU CLEANFIRE BURNING SYSTEM:

Components:

cover	1 pc.	used in burning pellets
mounting collar	1 pc.	adjusts the mounting height on the grate
cylinder	1 pc.	where gasification of the fuel takes place
fire tube	1 pc.	where gasified fuel from pellets burns
grates	2 pcs	for adjustment and cleaning of the combustion space
air pipe, 5 cm	1 pc.	controls and releases air into the chimney in pellet-burning

Assembly:

First install the grate with small holes at the bottom of the cylinder. Install the grate with large holes inside the cylinder, on top of the first grate. Fit the 5 cm air pipe to the 30 mm hole in the middle of the grate. Fit the octagonal fire tube to the large hole in the grate with large holes.

Installation:

The fireplace grate must have a 31 or 36 cm opening. The CF 40 requires an opening of 31 cm and the CF 60 a 36 cm opening for installation. Install the assembled cylinder in the opening so that it does not touch the edges of the opening and is supported by the mounting collar.

Placement in the fireplace grate opening:

Place the mounting collar around the fireplace grate opening and measure the distance to the bottom of the ash pit. At least 5 cm of space must be left for the ash between the bottom of the ash pit and the cylinder grate.

The cylinder features holes at intervals of 2 cm in three different sections for adjustment to the correct height with hex screws or 6 mm roll pins. Install the cylinder at the correct height.

Tulipippu Ay

Sorrantie 28, FI-34260 Terälahti, Finland

FAX / Answerphone: +358 3 378 4193

E-mail: tulipippu@tulipippu.com

www.tulipippu.com

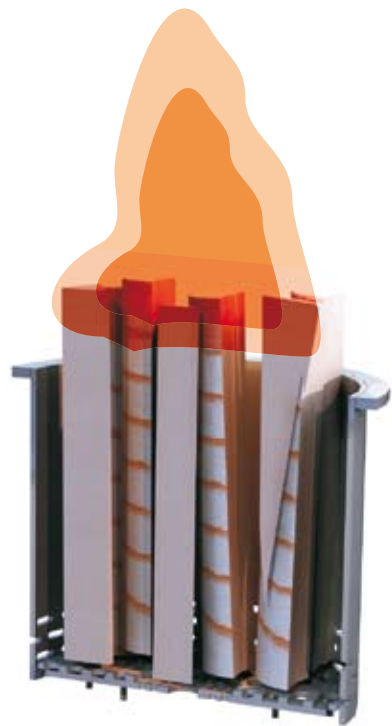
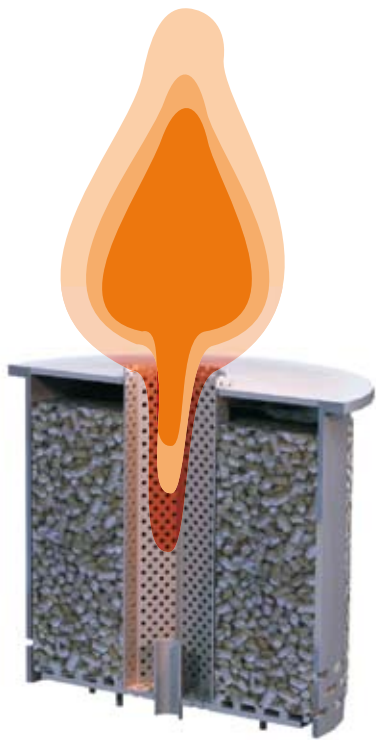

CleanFire burning instructions

Operating environment

The CleanFire system is intended for burning pellets or logs in your fireplace.

Burning pellets

To burn pellets, adjust the grate to its small, 7 mm hole by turning the fire tube. Ensure that the air pipe is in the 30 mm hole in the middle of the grate. Ensure that the octagonal fire tube is upright in the octagonal hole of the grate. Pour the necessary amount of pellets onto the grate, in the space between the fire tube and the cylinder.

Burning logs

To burn logs, open the holes in the grate entirely by turning the fire tube. Remove the octagonal fire tube from the grate before burning logs. Also remove the round air pipe from the 30 mm hole before burning logs, and remove the round cover plate as well first. Place the necessary amount of firewood inside the cylinder so that the logs are upright and in contact with each other. Light the firewood from the top using paper, birch bark, or a commercially available lighter fluid.

Always empty the ashes before using the system again. To dispose of the ashes, turn the grate holes fully open by turning the fire tube. Use a brush if necessary.

Lighting the burner

Follow the instructions and look after the environment. The procedures will become natural for you after a few times.

1. Open the cover and pour the necessary amount of pellets in the space between the cylinder and the fire tube. Note that you cannot add pellets until the beginning of the next burning.
2. Pour about 3 dl of pellets and 1 dl of grill lighter fluid into a flat-bottomed container. Allow about 10 minutes for the lighter fluid to be absorbed into the pellets.
3. Pour any unabsorbed lighter fluid onto the pellets or back into the bottle. Pour the fluid-saturated pellets into the bottom of the fire tube.
4. Ensure that air can flow freely from the air pipe to the fire tube. Close the burner cover.
5. Check that the fireplace damper and air intake are open.
6. Light the fluid-saturated pellets via the fire tube with a fireplace match or paper.
7. Look after the fire, and ensure safety right from the beginning, taking into account the appropriate fireplace adjustments.
The lighting phase lasts 5–15 minutes. The burner burns with a clean flame that is about 50 cm long. Adjust the chimney damper to as small a setting as possible when necessary. Enough combustion air should be supplied from below so that the fire does not decrease and the flame is yellowish. A brownish flame contains unburned substances and indicates a need for more air to be supplied upward.
8. Note that a larger-than-25-mm hole for carbon monoxide in the chimney damper lets out the gases during the dying-down phase and lets the lighter-than-air carbon monoxide into the chimney.
9. Ensure that the damper is closed at the right time and that the hole for carbon monoxide is open.
10. Note that pellet embers smoulder a long time and continue to release gas. Allow sufficient time for the first burnings and for monitoring the adjustments. The pellet fire in the CF system must not be mixed or poked. Also, pellets must not be added on top of the burning coals. Allow the fire to burn out, and enjoy it.

IMPORTANT NOTE!

Pellets moistened with lighter fluid for about 15 minutes must be used for lighting the fire in the fire tube. This is because the ash content of pellets is 0.5%, and such a small amount of ash is removed with the fire. When pellets are used for lighting a fire, the small air holes in the grate remain open, which is necessary to ensure successful burning.

Safety instructions

- Verify the correct functioning of your smoke detector.
- Use the correct type of lighter fluid only.
- We recommend a hole larger than 20 mm in the damper (consult the manufacturer for more information).
- Ensure that the parts are intact. Wear parts, such as chimney and grate, can be ordered with the CF spare part number as necessary.
- Pellet embers smoulder a long time, and the smoke flue must be kept open for a long time after the flames have gone out.
- If the room is equipped with an air-conditioning system, ensure before burning that it does not create a vacuum. A vacuum causes smoke to enter the room from the fireplace.
- Burning pellets release, e.g., carbon monoxide gas, which burns in the fireplace. Ensure that the damper is sufficiently open for the duration of the burning. As the fire dies down, there must be a hole in the damper for the release of carbon monoxide into the chimney.
- Pellets are efficient fuel that must not be added to burning embers. Clean burning requires the right size of burning system for the fireplace. The burning system enables heating with a single filling. Allow the CF system to cool down freely in the fireplace without stirring or poking.
- Ensure that your smoke detectors are fully operational, and follow the CF burning instructions.